



# Antelope Creek Ranch

W1/2-2,3,4,5,E1/2 6,  
portion E 1/2 7, 8,9,10, SW11, 16, 17,  
portion E1/2 18-19-16-W4M

**Description:** This 5,493 acre property is managed through the Antelope Creek management committee. The working ranch is used as an example for managing for sustainable ranching and conserving native habitat values.

**Partners:** Ducks Unlimited, Fish and Wildlife

**Special Restrictions:** Day use only. No open fires. Foot access only, except on designated routes. Follow special restrictions posted on property.

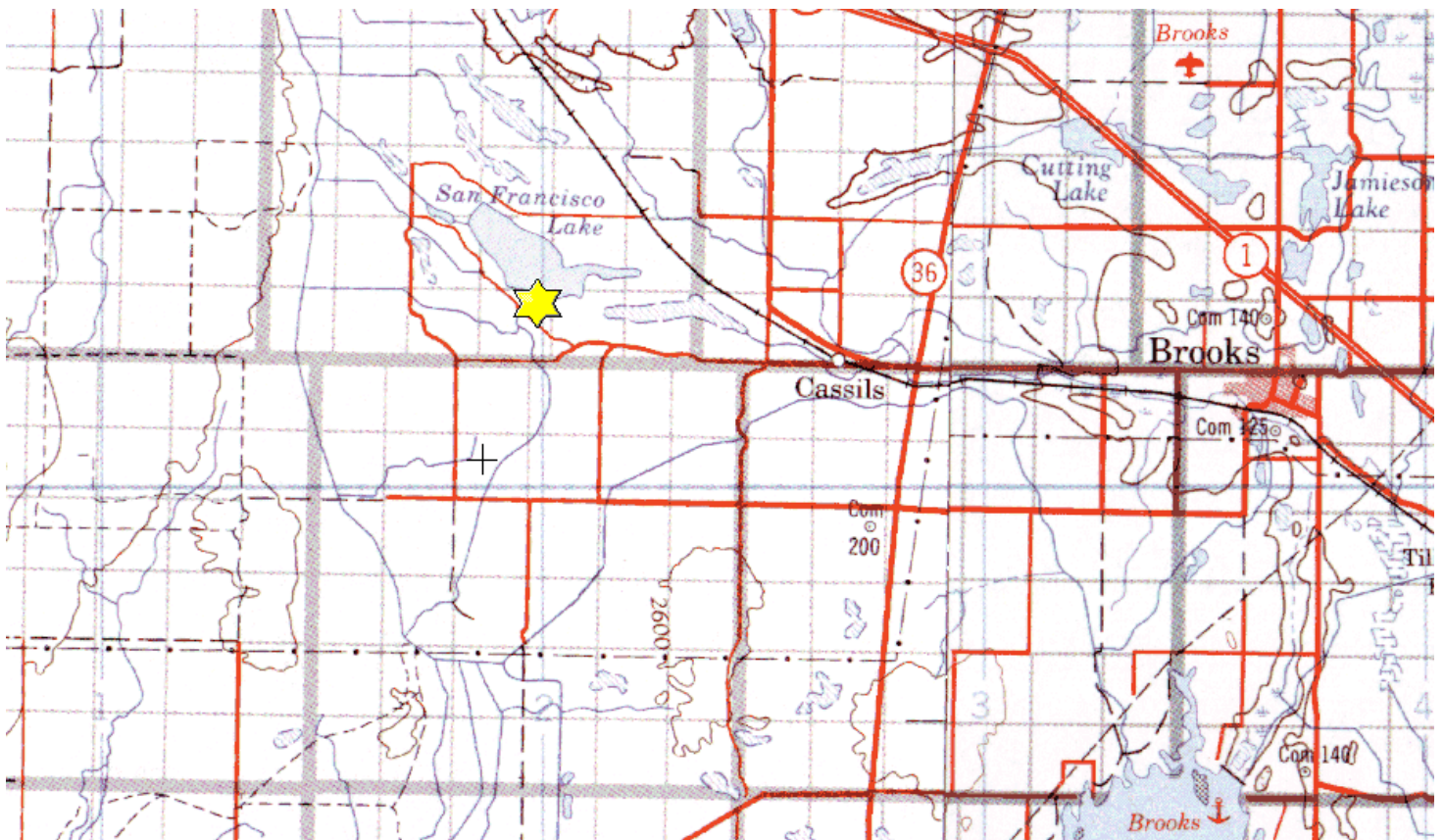



Alberta Fish & Game Association, 6924 - 104street, Edmonton Alberta, T6H 2L7

Phone: 780-437-2342, Fax: 780-438-6872

Email: [Office@afga.org](mailto:Office@afga.org)

Website: [www.afga.org](http://www.afga.org)